

MOUND TOWNSHIP CEMETERY.

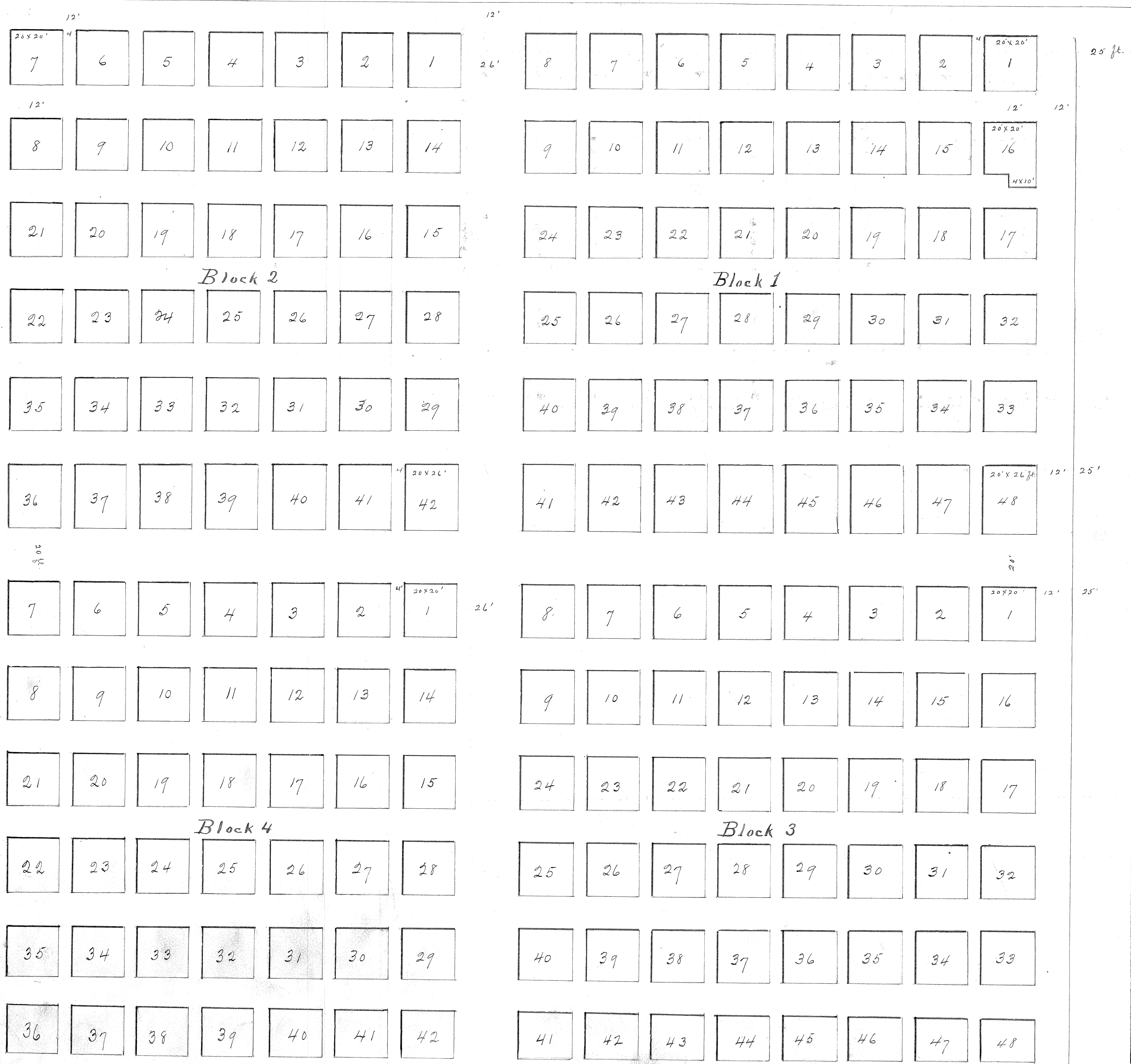

Commencing at the N. E. corner of the N.E. of Section 28, Township 21, South of Range 2 West of the 6th P.M. thence West 417 ⁴⁰/₁₀₀ ft. South 417 ⁴⁰/₁₀₀ ft. East 417 ⁴⁰/₁₀₀ ft. North 417 ⁴⁰/₁₀₀ ft. to point of beginning. And I further proceeded to divide said tract of land except so much thereof as is occupied for public highway, as shown on this plat into four blocks and lots & alleys, all lots being 20 x 20 ft. except lots from 41 to 48, in blk one and lots No. 36 to 42 in blk two inclusive are 20 x 26 ft. alleys East & West are 12 ft wide, North & South 4 ft except 12 ft driveway on East side and 12 ft driveway on North side. Witness my hand at McPherson, Kansas, this the 28 day of Mar. 1895.
 W. R. Durrall, County Surveyor of McPherson County, Kansas.

This certifies that Mound Township is the legal owner of the land upon which Mound Township Cemetery is situated, and that the officers of said Township have caused said land to be resurveyed and replatted as shown by the above plat and notes, the same being in accordance with the design and instruction of the officers of said township.
 In testimony whereof, the said officers of said Mound Township have hereunto affixed their official names this 21st day of November A. D. 1895.
 Peter H. Nedel, Trustee }
 J. J. Krehbiel, Clerk } of Mound Township.
 John P. Kaufman, Treasurer }

State of Kansas, } ss.
 McPherson County, } On this 21 day of November A. D. 1895, came Peter H. Nedel, as Trustee, J. J. Krehbiel, as Clerk, and John P. Kaufman as Treasurer of Mound Township, in said County and State, and acknowledged that they executed the said instrument as their free and voluntary act as said officers and the act of said Township.
 Witness my hand and official seal the day and year last above written.
 A. Ringwald, Reg. of Deeds.

State of Kansas, } ss.
 McPherson County, } A true copy of original as filed Nov. 21st 1895 at 2³⁰ o'clock P. M.
 A. Ringwald, Reg. of Deeds.